

Televes®

NEW PRODUCT 2016/2017





Televes®

PASSION FOR **QUALITY**

Televes expresses that this document is just for information purposes and does not accept any responsibility that could be originated from possible errors or omissions regarding its content.

The product pictures included are not contractual and Televes could supply products as shown or these could suffer variations, modifications and/or alterations at any time and without notice.



QR-A00371
Watch the video on Youtube
https://youtu.be/4dKq4Kg_L_Zw

DESIGNED TO LAST



This new range of satellite dishes is built using aluminium, fibreglass and stainless steel to guarantee the protection against rust.

Its improved structure has been designed to make assembly easier.



Flexible LNB holder
MADE OF FIBREGLASS

Hide the cables in the arm
MADE OF ALUMINIUM

Best performance against corrosion
ALUMINIUM DISH AND STAINLESS STEEL SCREWS



High resistance reflector bracket
MADE OF FIBREGLASS

Robust pole clamp and bracket with adjustable elevation angle
MADE OF ZAMAK

A full product range:

- ✓ Two sizes: 630 and 830
- ✓ Different packing options
- ✓ Up to 4 colors: O W G R

Every detail is important to reduce the assembly time:

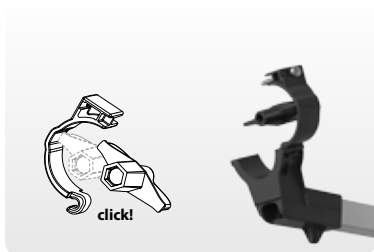

Integrated 10mm nut spinner in the LNB holder
Just break the plastic and tighten the nuts

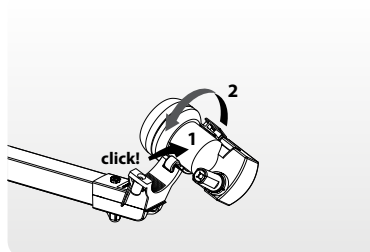

Fit the LNB in the holder and keep it fixed during the installation

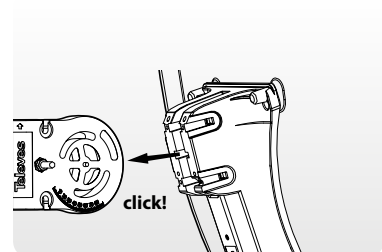

The reflector bracket fits easily on the elevation mechanism

AVANT 9

THE PROGRAMMABLE AMPLIFIER THAT WILL BEAT YOUR EXPECTATIONS IS COMING

- ✓ **A new size lighter and more compact**
(270 x 200 x 60 mm)
- ✓ **UHF filters with more selectivity**
30dB rejection to adjacent channel
- ✓ **Save energy**
Up to 25% less power consumption than previous models
- ✓ **Chassis made of ZAMAK**
Improved screening attenuation



MULTIPLE PROGRAMMING OPTIONS



Programmable via an Android App for smartphones and tablets

Use your mobile phone as a working tool to program your Avant



Auto programming

With the new Autoscan functionality the amplifier will automatically scan its UHF inputs and allocate the muxes found to filters.

(Only available on the PRO versions)



Backwards compatible and still programmable via your **current universal programmer or your PC**

And also:

- ✓ The App allows the channel level monitoring on the VHF and UHF bands
- ✓ 10 programmable UHF filters with adjustable bandwidth
- ✓ Automatic output signal adjustment
- ✓ Antenna or mast amplifiers automatically powered through the inputs (12V)
- ✓ LTE Ready
- ✓ Multiple inputs: FM, VHF, 120...862MHz, UHF (2 or 3) and satellite
- ✓ Two powering modes through the sat input: local and remote

A FULL PRODUCT RANGE ADAPTED TO YOUR REQUIREMENTS

AVANT 9 BASIC

2xUHF

532001: Terrestrial
532011: Terrestrial and satellite

AVANT 9 PRO

3xUHF, auto-programming, VHF & UHF monitoring

532021: Terrestrial
532031: Terrestrial and satellite

T.OX ENCODERS

UNLIMITED HD CONTENT OVER COAX OR IP

Add content from other sources to your distribution network easily with our T.OX encoders

- ✓ MPEG-2 & MPEG-4 (H.264) video encoding
- ✓ Audio Dolby Digital AC-3
- ✓ Autoscan of the input video resolution
- ✓ Low current consumption
- ✓ High output level in RF
- ✓ Wide band output (Bill, S-Band, UHF)
- ✓ Edition of service parameters as LCN, TS_ID, etc
- ✓ Configuration of COFDM/QAM parameters
- ✓ Two programming options: web interface or universal programmer

Single HDMI Encoder

Ref. 566001



Twin IP Encoder

Ref. 563852

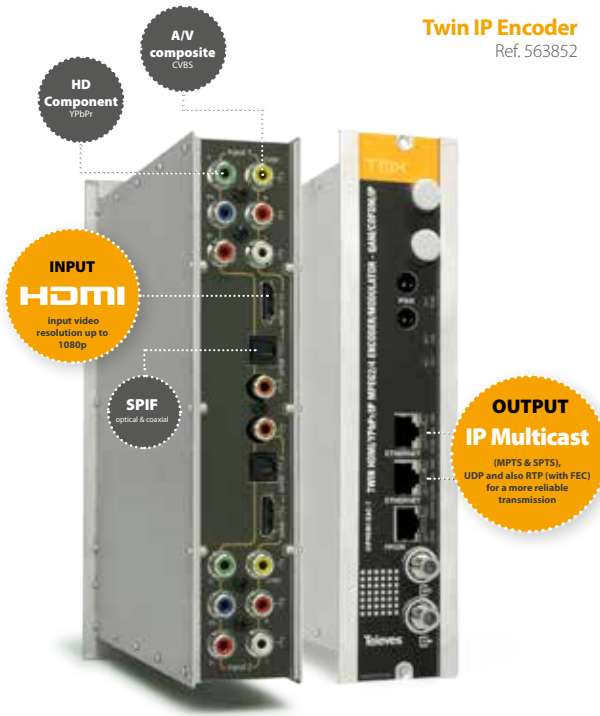

More encoders:

Quad A/V Composite - COFDM/QAM
(Ref.563822)

Twin HDMI or HD component - COFDM/QAM
(Ref.563832)

This encoder also allows operation in reverse mode:

It converts a multicast ip input (even a A/V source) to a RF output (COFDM/QAM). An interesting application to save internet bandwidth on GPON solutions (broadcast video overlay).

A NEW MEASURING EQUIPMENT: COMPACT & LIGHT BUT FULL OF FUNCTIONALITIES

H30FLEX

Highly customizable with software options for different TV standards (DVB-T/T2-S/S2-C)

Great measurements performance, including a digital real-time spectrum analyzer



MEASUREMENT EQUIPMENT:

- ✓ Easy to use
- ✓ High contrast sunlight readable screen
- ✓ Fast & Automatic channel auto-scan with parameters autodetection (system scan)

RANGE (WITH DOLBY):

593301	H30FLEX with DVB-S/S2 and DVB-T
593302	H30FLEX with DVB-S/S2 and DVB-T/T2

UPGRADES:

593231	DVB-T
593232	DVB-T/T2
593233	DVB-C
593234	dCSS (SCR)



▶ COMPACT, ROBUST AND LIGHT
IMPROVES INSTALLATION
PRODUCTIVITY

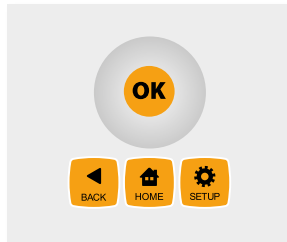

▶ ERGONOMIC HANDHELD DESIGN
USER-FRIENDLY INTERFACE

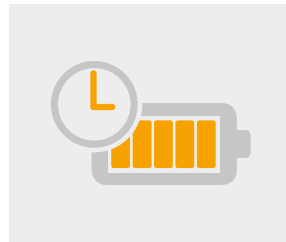

▶ LONG BATTERY RUNTIME
WITH CUSTOM ECONOMIC
PROFILE



▶ GREAT CONNECTIVITY
WITH CLOUD AUTO-UPDATE
FUNCTIONALITY



HANDHELD SPLICER

F.O. FUSION BY ELECTRIC ARC

Handheld fusion splicer capable of doing a **splice in 7 seconds**. Easy to carry thanks to its **small weight and dimensions**.

The product also includes a carry case with all the necessary accessories. Its **interface is very user friendly and intuitive**, all actions can be performed with just 3 buttons.

It **automatically detects problems** before the splice is done as it **measures the angles** in which the fibre has been cut (maybe pointing at a fault with the cleaver) and **faults** with the fibre (usually dust).

It will also **make sure the splice has been correctly done** by checking the spliced fibre **by pulling** and **measuring the optical losses**.



MAKE IT POSSIBLE WITH THE POWER OF THE LIGHT

Besides, it will also do the following:

- ✓ Alignment of the fibre for cladding
- ✓ Start the splicing process automatically once the cover is closed
- ✓ Calibration by insertion of one fibre
- ✓ Automatically clean the electrodes
- ✓ Saving a log with the information of the splice that can be afterwards exported to a different format
- ✓ Up to 60 splices/protection sleeve heating from a single full battery charge and possibility of re-charging battery whilst using the splicer
- ✓ Includes UK PSU





MMIC

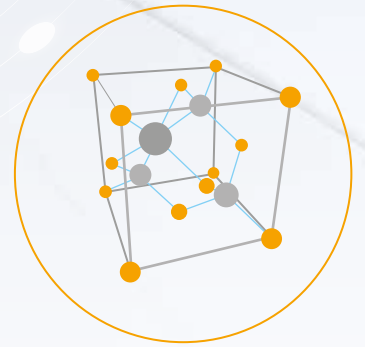

TForce is the technology used exclusively by Televes for the design, manufacture and assembly of its own **MMIC COMPONENTS**, a type of integrated circuit device that operates at microwave frequencies (300 MHz to 300 GHz).

Manufacturing MMIC circuits is done by altering chemical reactions with semiconductor composites such as Gallium Arsenide (GaAs), which offers certain benefits due to its capacity to work at high frequencies and its extreme resilience to interference.

MMIC makes it possible to integrate active devices, transmission lines and passive elements in a single substratum, building powerful circuits so small that special microscope lenses are required to operate with them.

31	33
GA	AS
69.723	74.921

GALLIUM-ARSENIDE
[GAAs]



QR-A00380
Watch the video on Youtube
<https://youtu.be/KCIWTesFoQA>

DATBOSS

WHEN YOU THOUGHT NOTHING COULD IMPROVE BOSSTECH FOR A PERFECTLY BALANCED DTT OUTPUT SIGNAL, **TELEVES INTRODUCES DAT BOSS TForce**

The same Gallium Arsenide (GaAs) technology utilized in aeronautics to recover signals from lost spacecraft is now incorporated into Televes DAT BOSS TForce antenna

The largest signal dynamic margin for a DTT antenna in the world

27% increased coverage range

T•FORCE
TECHNOLOGY

*If **DATBOSS TForce** can not detect it, it can not be seen!*



MOSAIQ₆



THE POWER OF USER EXPERIENCE



UP TO **6 SCREENS** IN ONE

- HIGH DEFINITION 8" SCREEN
- SERVICE BITRATE ANALYSER
- ALL RELEVANT MEASUREMENTS IN ONE DISPLAY
- PROFESSIONAL SPECTRUM ANALYSER IN REAL TIME
- ECHO REPRESENTATION FOR SFN NETWORK ANALYSIS
- CONSTELLATION DIAGRAM TO RECOGNISE THE TYPE OF INTERFERENCE

AVAILABLE
FROM **Q1 2017**



Televes[®]

PASSION FOR **QUALITY**



Televes®

NEW PRODUCT 2016/2017

